



Cover 2:  
Feathers Jewel

Cover 4:  
Pucker Teal

Cover 3:  
Whimsical Saffron

Cover 1:  
Villa Navy

Antique Feet

# Azure Collection

Colours represented are to be used as a guide only.  
Please refer to manufacturers swatch for a more accurate colour match. 11.01.2017

Please note that colour shadings can vary slightly from each roll of fabric.  
We cannot guarantee a precise match to these samples or between cut lengths and upholstered goods.

foamflex™  
Award Winning Seating Technology

02/02/2022

# AZURE COVER GUIDE - FIXED BACK

Please use this guide when ordering the following pieces to clarify cover options.

**4 Seater Modular Sofa (4MD)**

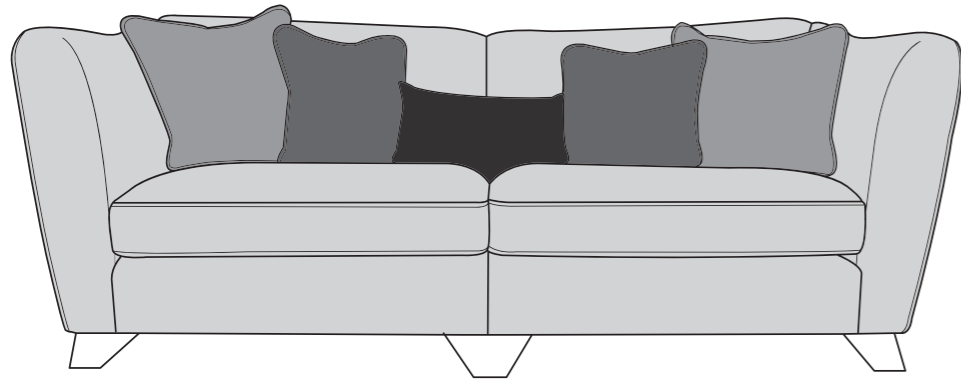

**3 Seater Sofa (3ST)**

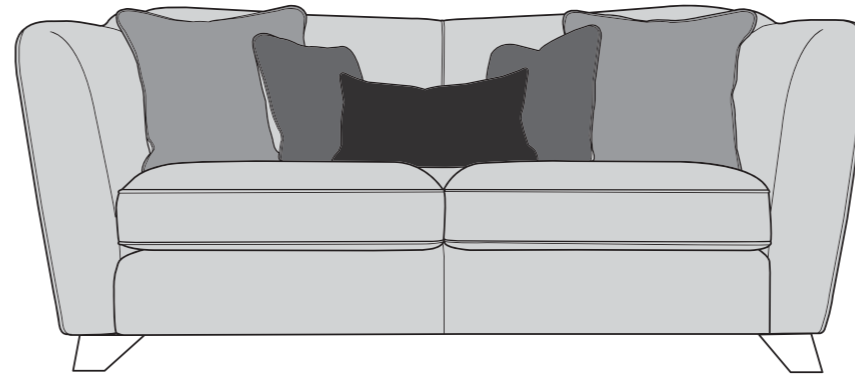

**2 Seater Sofa (2ST)**

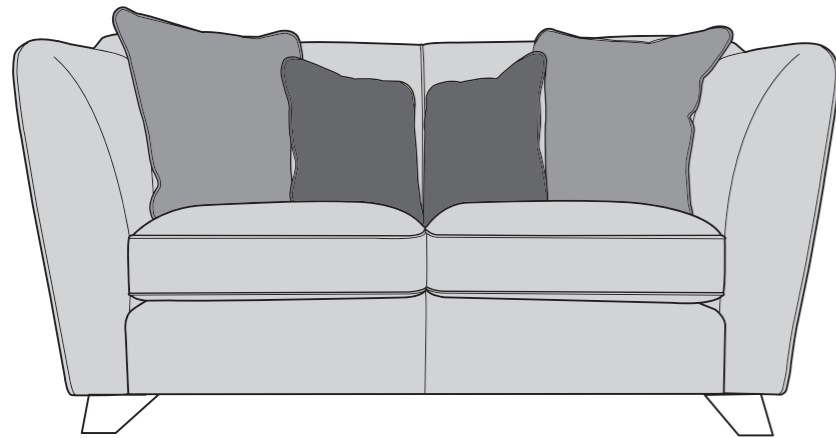

**Love Chair (LOV)**

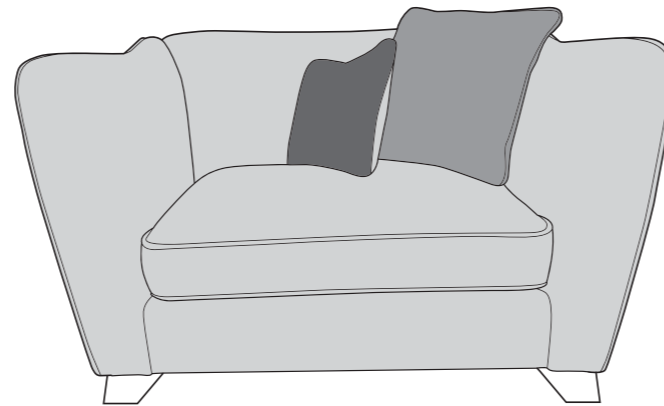

**Arm Chair (1ST)**

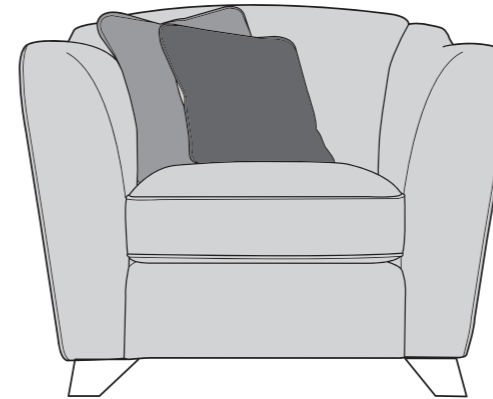



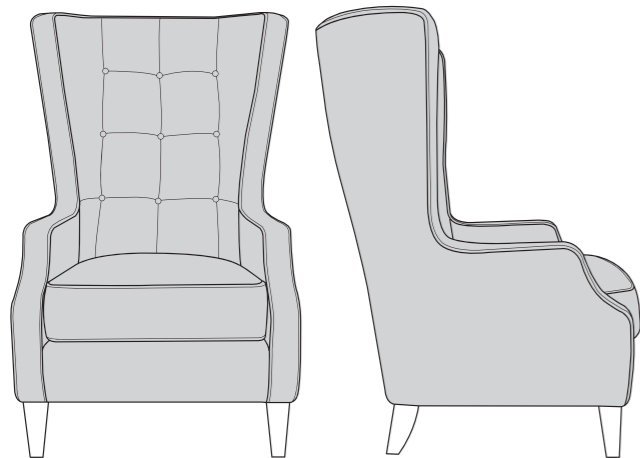

## SUGGESTED ACCENT PIECES

**Throne Chair (ACH)**

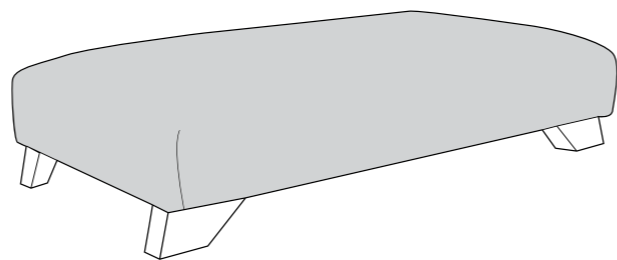

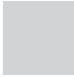
**Azure Footstool (FST)**



-  **COVER 1**  
(BODY)
-  **COVER 2**  
(SCATTER)
-  **COVER 3**  
(SCATTER)
-  **COVER 4**  
(BOLSTER)

Large & Medium  
Scatter Cushions

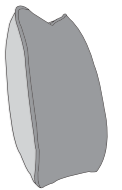

Flanged Edge  
Front = Cover 2  
Reverse = Cover 1

Small Scatter Cushions

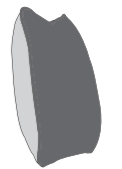

Flanged Edge  
Front = Cover 3  
Reverse = Cover 1

Bolster



Front = Cover 4  
Reverse = Cover 4

(Included in 4 & 3  
Seater Sofas)

Feather Filled  
Scatters & Bolster



APPROVED MEMBER



# AZURE DIMENSIONS (CM)

| AVAILABLE PIECES           | HEIGHT 1 | WIDTH 2 | DEPTH 3 | SEAT HEIGHT 4 | SEAT DEPTH (STD) 5 | SEAT WIDTH 6 | ACCESS DIAGONAL 7 | WEIGHT (KG) | SCATTER CUSHIONS |
|----------------------------|----------|---------|---------|---------------|--------------------|--------------|-------------------|-------------|------------------|
| 4 SEATER MODULAR SOFA (4M) | 90       | 242     | 99      | 52            | 69                 | 196          | 260               | 87          | 4 + 1 BOLSTER    |
| 4ML/4MR UNIT               | 90       | 121     | 99      | 52            | 69                 | 98           | N/A               | 87          | 2                |
| 3 SEATER SOFA              | 90       | 211     | 99      | 52            | 69                 | 165          | 229               | 71          | 4 + 1 BOLSTER    |
| 2 SEATER SOFA              | 90       | 182     | 99      | 52            | 69                 | 134          | 202               | 63.5        | 4                |
| LOVE CHAIR                 | 90       | 145     | 99      | 52            | 69                 | 97           | 127               | 60          | 2                |
| ARM CHAIR                  | 86       | 107     | 99      | 52            | 69                 | 63           | 140               | 44          | 2                |
| <b>ACCENT PIECES</b>       |          |         |         |               |                    |              |                   |             |                  |
| THRONE CHAIR               | 122      | 73      | 88      | 52            | 54                 | 55           | 102               | 28.5        | N/A              |
| AZURE FOOTSTOOL            | 33       | 102     | 62      | N/A           | N/A                | N/A          | 117               | 12.5        | N/A              |



- \* Hardwood & composite board frame.
- \* Dowelled, screwed, glued & stapled joinery.
- \* Available with dark, light or Smokey Grey Feet

- \* 4 seater modular sofa delivered as 2 units (LFS & RFS) for ease of delivery.
- \* Award winning foamflex seat interior with 5 year guarantee.
- \* Feather filled scatter cushions & bolster included for added luxury.



- \* Bolt on sofa arms for ease of delivery.
- \* Serpentine seat springs & silent wire.
- \* Superloop back springs.

## DIMENSION GUIDE

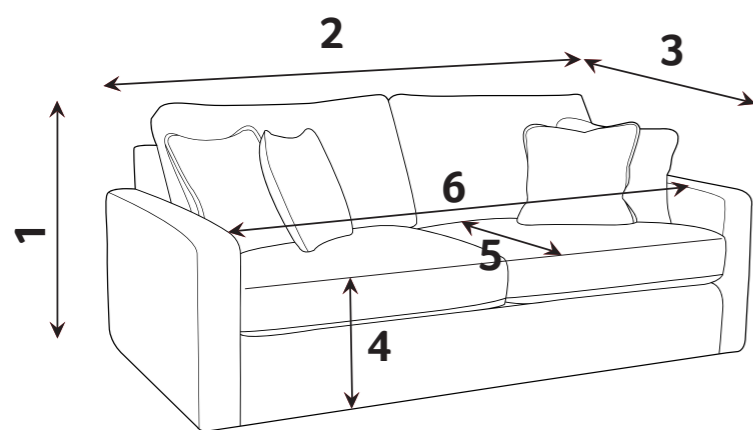

- 1 - HEIGHT
- 2 - WIDTH
- 3 - DEPTH
- 4 - SEAT HEIGHT
- 5 - SEAT DEPTH (STD & PILLOW)
- 6 - SEAT WIDTH
- 7 - DIAGONAL ACCESS

Check the diagonal access dimension to ensure furniture will fit in your home.

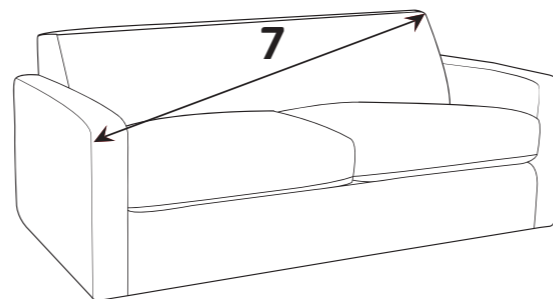

Illustrations used for reference only.

## foamflex™

Our new expertly engineered foam seat interior gives you the comfort of fibre with the retention of foam.

## CARE GUIDE

To improve the longevity of your hand-made furniture, we recommend rotating cushions (where applicable).

For further information on maintaining your furniture, please refer to the Care Guide located under the seat platform.



Our foamflex seat interiors have been granted the FIRA GOLD Award, a mark of quality under-pinning all necessary testing of the product materials, design and production techniques.

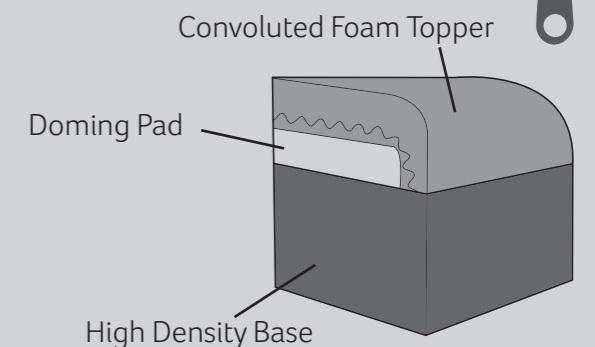

## FOOT OPTIONS:



Please note : All dimensions are approximate. Allow tolerance of +/- 2.5cm.

Wood is a natural product and will vary in shade/colour from item to item. Feet may require fitting.